

Application for a premises licence to be granted under the Licensing Act 2003

Please read the following instructions first

Before completing this form please read the guidance notes at the end of the form. If you are completing this form by hand please write legibly in block capitals. In all cases ensure that your answers are inside the boxes and written in black ink. Use additional sheets if necessary.

You may wish to keep a copy of the completed form for your records.

I/We **LI RETAIL LTD**

(Insert name(s) of applicant)

apply for a premises licence under section 17 of the Licensing Act 2003 for the premises described in Part 1 below (the premises) and I/we are making this application to you as the relevant licensing authority in accordance with section 12 of the Licensing Act 2003

Part 1 – Premises details

Postal address of premises or, if none, ordnance survey map reference or description			
24 Bridgeway Center, The Meadows			
Post town	Nottingham	Postcode	NG2 2JD

Telephone number at premises (if any)	+447440343433
Non-domestic rateable value of premises	£ 5200

Part 2 - Applicant details

Please state whether you are applying for a premises licence as **appropriate** **Please tick as**

a)	an individual or individuals *	<input type="checkbox"/>	please complete section (A)
b)	a person other than an individual *	<input type="checkbox"/>	
i	as a limited company/limited liability partnership	<input checked="" type="checkbox"/>	please complete section (B)
ii	as a partnership (other than limited liability)	<input type="checkbox"/>	please complete section (B)
iii	as an unincorporated association or	<input type="checkbox"/>	please complete section (B)
iv	other (for example a statutory corporation)	<input type="checkbox"/>	please complete section (B)

c)	a recognised club	<input type="checkbox"/>	please complete section (B)
d)	a charity	<input type="checkbox"/>	please complete section (B)
e)	the proprietor of an educational establishment	<input type="checkbox"/>	please complete section (B)
f)	a health service body	<input type="checkbox"/>	please complete section (B)
g)	a person who is registered under Part 2 of the Care Standards Act 2000 (c14) in respect of an independent hospital in Wales	<input type="checkbox"/>	please complete section (B)
ga)	a person who is registered under Chapter 2 of Part 1 of the Health and Social Care Act 2008 (within the meaning of that Part) in an independent hospital in England	<input type="checkbox"/>	please complete section (B)
h)	the chief officer of police of a police force in England and Wales	<input type="checkbox"/>	please complete section (B)

* If you are applying as a person described in (a) or (b) please confirm (by ticking yes to one box below):

- I am carrying on or proposing to carry on a business which involves the use of the premises for licensable activities; or X
- I am making the application pursuant to a
- statutory function or
- a function discharged by virtue of Her Majesty's prerogative

(A) individual applicants (fill in as applicable)

Title			
Surname			
First names			
Date of birth		I am 18 year old or over	<input type="checkbox"/>
Nationality			
Current residential address if different from premises address			
Post town		Postcode	
Daytime contact telephone number			
E-mail address (optional)			

Where applicable (if demonstrating a right to work via the Home Office online right to work checking service), the 'share code' provided to the applicant by that service

Second individual applicant (if applicable)

Mr	Mrs	Miss	Ms	Other Title (for example, Rev)	
Surname			First names		
Date of birth or over		I am 18 years old		Please tick yes	
Nationality					
Current residential address if different from premises address					
Post town				Postcode	
Daytime contact telephone number					
E-mail address (optional)					
Where applicable (if demonstrating a right to work via the Home Office online right to work checking service), the 'share code' provided to the applicant by that service: (please see note 15 for information)					

(B) Other applicants

Please provide name and registered address of applicant in full. Where appropriate please give any registered number. In the case of a partnership or other joint venture (other than a body corporate), please give the name and address of each party concerned.

Name	LI RETAIL LTD
Address	55 Wilton Avenue, Hampton Gardens, Peterborough, England, PE7 8RQ
Registered number (where applicable)	
16544043	

Description of applicant (for example, partnership, company, unincorporated association etc.)	
Private Limited Company	
Telephone number (if any)	+447440343433
E-mail address (optional)	upendar.banda@gmail.com

Part 3 Operating Schedule

When do you want the premises licence to start?

DD	MM	YYYY

If you wish the licence to be valid only for a limited period, when do you want it to end?

DD	MM	YYYY

<p>Please give a general description of the premises (please read guidance note 1)</p> <p>The premises will operate as a Post Office and convenience store, located on the ground floor only, with a total area of approximately 720 square feet. In addition to everyday household items and groceries, the business will provide Post Office services, including parcel handling, mail services, bill payments, and other associated counter services. The retail offer will also include the sale of beer, wine, and spirits as part of the convenience store operation.</p>

If 5,000 or more people are expected to attend the premises at any one time, please state the number expected to attend.

What licensable activities do you intend to carry on from the premises?

(please see sections 1 and 14 and Schedules 1 and 2 to the Licensing Act 2003)

Provision of regulated entertainment (please read guidance note 2)		Please tick all that apply
a)	plays (if ticking yes, fill in box A)	<input type="checkbox"/>
b)	films (if ticking yes, fill in box B)	<input type="checkbox"/>
c)	indoor sporting events (if ticking yes, fill in box C)	<input type="checkbox"/>
d)	boxing or wrestling entertainment (if ticking yes, fill in box D)	<input type="checkbox"/>
e)	live music (if ticking yes, fill in box E)	<input type="checkbox"/>
f)	recorded music (if ticking yes, fill in box F)	<input type="checkbox"/>
g)	performances of dance (if ticking yes, fill in box G)	<input type="checkbox"/>
h)	anything of a similar description to that falling within (e), (f) or (g) (if ticking yes, fill in box H)	<input type="checkbox"/>

<u>Provision of late night refreshment</u> (if ticking yes, fill in box I)	<input type="checkbox"/>
<u>Supply of alcohol</u> (if ticking yes, fill in box J)	<input checked="" type="checkbox"/>

In all cases complete boxes K, L and M

A

Plays Standard days and timings (please read guidance note 7)			<u>Will the performance of a play take place indoors or outdoors or both – please tick</u> (please read guidance note 3)	
Day	Start	Finish		
Mon			<u>Please give further details here</u> (please read guidance note 4)	
Tue				
Wed			<u>State any seasonal variations for performing plays</u> (please read guidance note 5)	
Thur				
Fri			<u>Non standard timings. Where you intend to use the premises for the performance of plays at different times to those listed in the column on the left, please list</u> (please read guidance note 6)	
Sat				
Sun				

B

Films Standard days and timings (please read guidance note 7)			<u>Will the exhibition of films take place indoors or outdoors or both – please tick</u> (please read guidance note 3)	
Day	Start	Finish		
Mon			<u>Please give further details here</u> (please read guidance note 4) <div></div>	
Tue				
Wed			<u>State any seasonal variations for the exhibition of films</u> (please read guidance note 5) <div></div>	
Thur				
Fri			<u>Non standard timings. Where you intend to use the premises for the exhibition of films at different times to those listed in the column on the left, please list</u> (please read guidance note 6) <div></div>	
Sat				
Sun				

C

Indoor sporting events Standard days and timings (please read guidance note 7)			<u>Please give further details here</u> (please read guidance note 4) <div></div>
Day	Start	Finish	
Mon			
Tue			
Wed			<u>State any seasonal variations for indoor sporting events</u> (please read guidance note 5) <div></div>
Thur			
Fri			<u>Non standard timings. Where you intend to use the premises for indoor sporting events at different times to those listed in the column on the left, please list</u> (please read guidance note 6) <div></div>
Sat			
Sun			

D

Boxing or wrestling entertainments Standard days and timings (please read guidance note 7)			<u>Will the boxing or wrestling entertainment take place indoors or outdoors or both – please tick</u> (please read guidance note 3)	
Day	Start	Finish		
Mon			<u>Please give further details here</u> (please read guidance note 4)	
Tue				
Wed			<u>State any seasonal variations for boxing or wrestling entertainment</u> (please read guidance note 5)	
Thur				
Fri			<u>Non standard timings. Where you intend to use the premises for boxing or wrestling entertainment at different times to those listed in the column on the left, please list</u> (please read guidance note 6)	
Sat				
Sun				

E

Live music Standard days and timings (please read guidance note 7)			<u>Will the performance of live music take place indoors or outdoors or both – please tick</u> (please read guidance note 3)	
Day	Start	Finish		
Mon			<u>Please give further details here</u> (please read guidance note 4)	
Tue				
Wed			<u>State any seasonal variations for the performance of live music</u> (please read guidance note 5)	
Thur				
Fri			<u>Non standard timings. Where you intend to use the premises for the performance of live music at different times to those listed in the column on the left, please list</u> (please read guidance note 6)	
Sat				
Sun				

F

Recorded music Standard days and timings (please read guidance note 7)			<u>Will the playing of recorded music take place indoors or outdoors or both – please tick</u> (please read guidance note 3)	
Day	Start	Finish		
Mon			<u>Please give further details here</u> (please read guidance note 4)	
Tue				
Wed			<u>State any seasonal variations for the playing of recorded music</u> (please read guidance note 5)	
Thur				
Fri			<u>Non standard timings. Where you intend to use the premises for the playing of recorded music at different times to those listed in the column on the left, please list</u> (please read guidance note 6)	
Sat				
Sun				

G

Performances of dance Standard days and timings (please read guidance note 7)			<u>Will the performance of dance take place indoors or outdoors or both – please tick</u> (please read guidance note 3)	
Day	Start	Finish		
Mon			<u>Please give further details here</u> (please read guidance note 4)	
Tue				
Wed			<u>State any seasonal variations for the performance of dance</u> (please read guidance note 5)	
Thur				
Fri			<u>Non standard timings. Where you intend to use the premises for the performance of dance at different times to those listed in the column on the left, please list</u> (please read guidance note 6)	
Sat				
Sun				

H

Anything of a similar description to that falling within (e), (f) or (g) Standard days and timings (please read guidance note 7)			<u>Please give a description of the type of entertainment you will be providing</u> 	
Day	Start	Finish	<u>Will this entertainment take place indoors or outdoors or both – please tick</u> (please read guidance note 3)	
Mon				
Tue			<u>Please give further details here</u> (please read guidance note 4)	
Wed				
Thur			<u>State any seasonal variations for entertainment of a similar description to that falling within (e), (f) or (g)</u> (please read guidance note 5)	
Fri				
Sat			<u>Non standard timings. Where you intend to use the premises for the entertainment of a similar description to that falling within (e), (f) or (g) at different times to those listed in the column on the left, please list</u> (please read guidance note 6)	
Sun				

I

Late night refreshment Standard days and timings (please read guidance note 7)			Will the provision of late night refreshment take place indoors or outdoors or both – please tick (please read guidance note 3)	
Day	Start	Finish		
Mon			<u>Please give further details here</u> (please read guidance note 4)	
Tue				
Wed			<u>State any seasonal variations for the provision of late night refreshment</u> (please read guidance note 5)	
Thur				
Fri			<u>Non standard timings. Where you intend to use the premises for the provision of late night refreshment at different times, to those listed in the column on the left, please list</u> (please read guidance note 6)	
Sat				
Sun				

J

Supply of alcohol Standard days and timings (please read guidance note 7)			Will the supply of alcohol be for consumption – please tick (please read guidance note 8)	Off-Premises
Day	Start	Finish		
Mon	07:00-22:00	State any seasonal variations for the supply of alcohol (please read guidance note 5) No seasonal variation.		
Tue	07:00-22:00			
Wed	07:00-22:00			
Thur	07:00-22:00			
Fri	07:00-22:00	Non standard timings. Where you intend to use the premises for the supply of alcohol at different times to those listed in the column on the left, please list (please read guidance note 6) No non-standard or odd timings.		
Sat	07:00-22:00			
Sun	07:00-22:00			

State the name and details of the individual whom you wish to specify on the licence as designated premises supervisor (Please see declaration about the entitlement to work in the checklist at the end of the form):

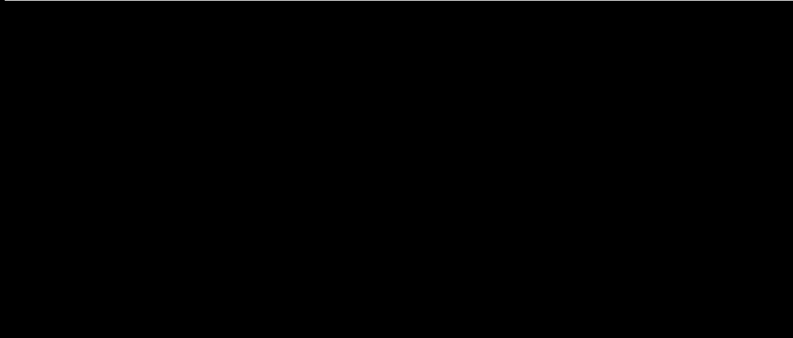
Name	Mrs Sushma Jakkidi
Date of birth	
Address	
Postcode	
Personal licence number (if known)	
Issuing licensing authority (if known)	Nottingham Council

K

Please highlight any adult entertainment or services, activities, other entertainment or matters ancillary to the use of the premises that may give rise to concern in respect of children (please read guidance note 9).

No adult entertainment or services will be provided.

L

Hours premises are open to the public Standard days and timings (please read guidance note 7)			<u>State any seasonal variations</u> (please read guidance note 5) <div>No seasonal variations.</div>
Day	Start	Finish	
Mon	07:00-22:00		
Tue	07:00-22:00		
Wed	07:00-22:00		
Thur	07:00-22:00		
Fri	07:00-22:00		
Sat	07:00-22:00		
Sun	07:00-22:00		
			<u>Non standard timings. Where you intend to use the Non standard timings. Where you intend the premises to be open to the public at different times from those listed in the column on the left, please list</u> (please read guidance note 6) <div>No non-standard or odd timings.</div>

M

Describe the steps you intend to take to promote the four licensing objectives:

a) General – all four licensing objectives (b, c, d and e) (please read guidance note 10)

G01: Prominent, clear notices shall be displayed at every public entrance stating the actual operating hours of the premises.

b) The prevention of crime and disorder

CD1: All staff engaged in licensable activity at the premises will receive training and information in relation to the following:

- i. The Challenge 25 scheme in operation at the premises, including the forms of identification that are acceptable.
- ii. The hours and activities permitted by the premises licence issued under the Licensing Act 2003 and conditions attached to the licence.
- iii. How to complete and maintain the refusal register in operation at the premises (in relation to the sale of alcohol).
- iv. Recognising the signs of drunkenness.
- v. The operating procedures for refusing service to any person who is drunk, under-age or appears to be under-age, or appears to be making a proxy purchase.
- vi. Action to be taken in the event of an emergency, including reporting an incident to the emergency services.

Training shall be recorded in documentary form and shall be regularly refreshed at no greater than 12 month intervals. Training records shall be made available for inspection and copying at reasonable times upon request of an authorised officer of a responsible authority. Training records will be retained for at least 12 months.

CD2: An incident log shall be kept and maintained at the premises which will include a log of the following, including pertinent details:

- i. Any incidents of disorder or of a violent or antisocial nature;
- ii. All crimes reported to the venue, or by the venue to the police;
- iii. All ejections of patrons;
- iv. Any complaints received;
- v. Seizures of drugs or offensive weapons;
- vi. Any faults in the CCTV system;
- vii. Any visits by a responsible authority (under the Licensing Act 2003) or emergency service.

Records must be completed within 24 hours of any incident, and will contain the time and date, the nature of the incident, the people involved, the action taken and details of the person responsible for the management of the premises at the time of the incident. The logs shall be kept for at least 12 months following the date of entry and be made available for inspection and copying upon request of an authorised officer of a responsible authority.

CD3: The premises shall install, operate, and maintain a comprehensive digital colour CCTV system to the satisfaction of the Police. All public areas of the licensed premises including entry and exit points will be covered. The system must record clear images permitting the identification of individuals, and in particular enable facial recognition images (a clear head and shoulder image) of every person entering and leaving in any light condition. The CCTV system will continually record whilst the premises are open for licensable activities and during all times when customers remain on the premises. All equipment must have a constant and accurate time and date generation. All recordings will be stored for a minimum period of 31 days with date and time stamping. Recordings will be made available immediately upon the request of an authorised officer of a responsible authority throughout the entire 31 day period. The CCTV system will be capable of downloading images to a recognisable viewable format. The CCTV system will capture a minimum of 4 frames per second. The CCTV system will be fitted with security functions to prevent recordings being tampered with, i.e., be password protected.

CD4: All alcohol on display will be in such a position so as not to be obscured from the constant view of the staff.

CD5: In the event that an incident occurs for which the police have been called, the crime scene shall be preserved to enable police to carry out a full forensic investigation.

c) Public safety

PS1: The maximum number of persons (including staff) allowed at the premises shall not exceed 10.

d) The prevention of public nuisance

PN1: A telephone number shall be made available and displayed in a prominent location where it can conveniently be read from the exterior of the premises by the public for local residents to contact in the case of noise-nuisance or anti-social behaviour by persons or activities associated with the premises. The telephone number will be a direct number to the management who are in control during opening hours. A record will be kept by management of all calls received, including the time, date and information of the caller, including action taken following the call. Records will be made available for inspection and copying by an authorised officer of a responsible authority throughout the trading hours of the premises.

PN2: No deliveries (in relation to licensable activities) to the premises shall take place between 23:00 hours and 07:00 hours.

PN3 During the hours of operation of the premises, sufficient measures will be taken to remove and prevent litter and waste arising or accumulating from customers in the area immediately outside the premises.

PN4: No collections of waste or recycling materials (including bottles) from the premises shall take place between 23:00 hours and 07:00 hours on the following day.

e) The protection of children from harm

CH1: All staff, supervisors and managers must be trained in the legality and procedure of alcohol sales, prior to undertaking the sale of alcohol and then at least every 12 months. Training shall be signed and documented. Training records must be kept on the premises and be made available for inspection and copying to an authorised officer of a responsible authority on request. The documentation relating to training should extend back to a period of at least 12 months and should specify the time, date and details of the persons both providing the training and receiving the training.

CH2: There will be in place a written age verification policy in relation to the sale or supply of alcohol, which will specify a Challenge 25 proof of age requirement. This means that staff working at the premises must ask individuals who appear to be under 25 years of age, attempting to purchase alcohol, to produce identification. The only acceptable identification documents will be:

- A photo driving licence
- A passport

- An identification card carrying the PASS hologram

Unless such identification is produced the sale of alcohol must be refused.

This policy will include documented steps taken to prevent adults from purchasing alcohol for or on behalf of children under 18.

CH3: The premises shall display prominent signage indicating at any point of sale that a Challenge 25 scheme is in operation.

CH4: An alcohol sales refusal register shall be kept at the premises and be maintained to include details of all alcohol sales refused. The register will include:

- i. the date and time of refusal
- ii. the reason for refusal
- iii. details of the person refusing the sale
- iv. description of the customer
- v. any other relevant observations

The refusals register will be made available for inspection and copying on request of an authorised officer of a responsible authority. All entries must be made within 24 hours of the refusal.

Part 4 – Signatures (please read guidance note 11)

Signature of applicant or applicant's solicitor or other duly authorised agent (see guidance note 12). **If signing on behalf of the applicant, please state in what capacity.**

Declaration	<ul style="list-style-type: none">• [Applicable to individual applicants only, including those in a partnership which is not a limited liability partnership] I understand I am not entitled to be issued with a licence if I do not have the entitlement to live and work in the UK (or if I am subject to a condition preventing me from doing work relating to the carrying on of a licensable activity) and that my licence will become invalid if I cease to be entitled to live and work in the UK (please read guidance note 15).• The DPS named in this application form is entitled to work in the UK (and is not subject to conditions preventing him or her from doing work relating to a licensable activity) and I have seen a copy of his or her proof of entitlement to work, or have conducted an online right to work check using the Home Office online right to work checking service which confirmed their right to work (please see note 15)
Signature	<i>Upender Banda</i>
Date	06/01/2025
Capacity	Director

For joint applications, signature of 2nd applicant or 2nd applicant's solicitor or other authorised agent (please read guidance note 13). **If signing on behalf of the applicant, please state in what capacity.**

Signature	
Date	
Capacity	

Contact name (where not previously given) and postal address for correspondence associated with this application (please read guidance note 14)

Post town		Postcode	
Telephone number (if any)			
If you would prefer us to correspond with you by e-mail, your e-mail address (optional)			

Notes for Guidance

1. Describe the premises, for example the type of premises, its general situation and layout and any other information which could be relevant to the licensing objectives. Where your application includes off-supplies of alcohol and you intend to provide a place for consumption of these off-supplies, you must include a description of where the place will be and its proximity to the premises.
2. In terms of specific regulated entertainments please note that:
 - Plays: no licence is required for performances between 08:00 and 23.00 on any day, provided that the audience does not exceed 500.
 - Films: no licence is required for 'not-for-profit' film exhibition held in community premises between 08.00 and 23.00 on any day provided that the audience does not exceed 500 and the organiser (a) gets consent to the screening from a person who is responsible for the premises; and (b) ensures that each such screening abides by age classification ratings.
 - Indoor sporting events: no licence is required for performances between 08.00 and 23.00 on any day, provided that the audience does not exceed 1000.
 - Boxing or Wrestling Entertainment: no licence is required for a contest, exhibition or display of Greco-Roman wrestling, or freestyle wrestling between 08.00 and 23.00 on any day, provided that the audience does not exceed 1000. Combined fighting sports – defined as a contest, exhibition or display which combines boxing or wrestling with one or more martial arts – are licensable as a boxing or wrestling entertainment rather than an indoor sporting event.
 - Live music: no licence permission is required for:
 - a performance of unamplified live music between 08.00 and 23.00 on any day, on any premises.
 - a performance of amplified live music between 08.00 and 23.00 on any day on premises authorised to sell alcohol for consumption on those premises, provided that the audience does not exceed 500.
 - a performance of amplified live music between 08.00 and 23.00 on any day, in a workplace that is not licensed to sell alcohol on those premises, provided that the audience does not exceed 500.
 - a performance of amplified live music between 08.00 and 23.00 on any day, in a church hall, village hall, community hall, or other similar community premises, that is not licensed by a premises licence to sell alcohol, provided that (a) the audience does not exceed 500, and (b) the organiser gets consent for the performance from a person who is responsible for the premises.
 - a performance of amplified live music between 08.00 and 23.00 on any day, at the non-residential premises of (i) a local authority, or (ii) a school, or (iii) a hospital, provided that (a) the audience does not exceed 500, and (b) the organiser gets consent for the performance on the relevant premises from: (i) the local authority concerned, or (ii) the school or (iii) the health care provider for the hospital.
 - Recorded Music: no licence permission is required for:

- any playing of recorded music between 08.00 and 23.00 on any day on premises authorised to sell alcohol for consumption on those premises, provided that the audience does not exceed 500.
 - any playing of recorded music between 08.00 and 23.00 on any day, in a church hall, village hall, community hall, or other similar community premises, that is not licensed by a premises licence to sell alcohol, provided that (a) the audience does not exceed 500, and (b) the organiser gets consent for the performance from a person who is responsible for the premises.
 - any playing of recorded music between 08.00 and 23.00 on any day, at the non-residential premises of (i) a local authority, or (ii) a school, or (iii) a hospital, provided that (a) the audience does not exceed 500, and (b) the organiser gets consent for the performance on the relevant premises from: (i) the local authority concerned, or (ii) the school proprietor or (iii) the health care provider for the hospital.
 - Dance: no licence is required for performances between 08.00 and 23.00 on any day, provided that the audience does not exceed 500. However, a performance which amounts to adult entertainment remains licensable.
 - Cross activity exemptions: no licence is required between 08.00 and 23.00 on any day, with no limit on audience size for:
 - any entertainment taking place on the premises of the local authority where the entertainment is provided by or on behalf of the local authority;
 - any entertainment taking place on the hospital premises of the health care provider where the entertainment is provided by or on behalf of the health care provider;
 - any entertainment taking place on the premises of the school where the entertainment is provided by or on behalf of the school proprietor; and
 - any entertainment (excluding films and a boxing or wrestling entertainment) taking place at a travelling circus, provided that (a) it takes place within a moveable structure that accommodates the audience, and (b) that the travelling circus has not been located on the same site for more than 28 consecutive days.
3. Where taking place in a building or other structure please tick as appropriate (indoors may include a tent).
 4. For example the type of activity to be authorised, if not already stated, and give relevant further details, for example (but not exclusively) whether or not music will be amplified or unamplified.
 5. For example (but not exclusively), where the activity will occur on additional days during the summer months.
 6. For example (but not exclusively), where you wish the activity to go on longer on a particular day e.g. Christmas Eve.
 7. Please give timings in 24 hour clock (e.g. 16.00) and only give details for the days of the week when you intend the premises to be used for the activity.
 8. If you wish people to be able to consume alcohol on the premises, please tick 'on the premises'. If you wish people to be able to purchase alcohol to consume away from the premises, please tick 'off the premises'. If you wish people to be able to do both, please tick 'both'.

9. Please give information about anything intended to occur at the premises or ancillary to the use of the premises which may give rise to concern in respect of children, regardless of whether you intend children to have access to the premises, for example (but not exclusively) nudity or semi-nudity, films for restricted age groups or the presence of gaming machines.
10. Please list here steps you will take to promote all four licensing objectives together.
11. The application form must be signed.
12. An applicant's agent (for example solicitor) may sign the form on their behalf provided that they have actual authority to do so.
13. Where there is more than one applicant, each of the applicants or their respective agent must sign the application form.
14. This is the address which we shall use to correspond with you about this application.
15. Entitlement to work/immigration status for individual applicants and applications from partnerships which are not limited liability partnerships:

A licence may not be issued to an individual or an individual in a partnership which is not a limited liability partnership who is resident in the UK who:

- does not have the right to live and work in the UK; or
- is subject to a condition preventing him or her from doing work relating to the carrying on of a licensable activity.

Any licence issued in respect of an application made on or after 6 April 2017 will become invalid if the holder ceases to be entitled to work in the UK.

Applicants must demonstrate that they have the right to work in the UK and are not subject to a condition preventing them from doing work relating to the carrying on of a licensable activity.

They do this in one of two ways:

- 1) by providing with this application, copies or scanned copies of the documents which an applicant has provided, to demonstrate their entitlement to work in the UK (which do not need to be certified) as per information published on gov.uk and in guidance.
- 2) by providing their 'share code' to enable the licensing authority to carry out a check using the Home Office online right to work checking service (see below).

Home Office online right to work checking service.

As an alternative to providing a copy of original documents, applicants may demonstrate their right to work by allowing the licensing authority to carry out a check with the Home Office online right to work checking service.

To demonstrate their right to work via the Home Office online right to work checking service, applicants should include in this application their share code (provided to them upon accessing the service at <https://www.gov.uk/prove-right-to-work>) which, along with the applicant's date of birth, will allow the licensing authority to carry out the check.

In order to establish the applicant's right to work, the check will need to indicate that the applicant is allowed to work in the United Kingdom and is not



subject to a condition preventing them from doing work relating to the carrying on of a licensable activity.

An online check will not be possible in all circumstances because not all applicants will have an immigration status that can be shared digitally. The Home Office online right to work checking service sets out what information and/or documentation applicants will need in order to access the service. Applicants who are unable to obtain a share code from the service should submit copies of documents as set out above.

Your right to work will be checked as part of your licensing application and this could involve us checking your immigration status with the Home Office. We may otherwise share information with the Home Office. Your licence application will not be determined until you have complied with this guidance.

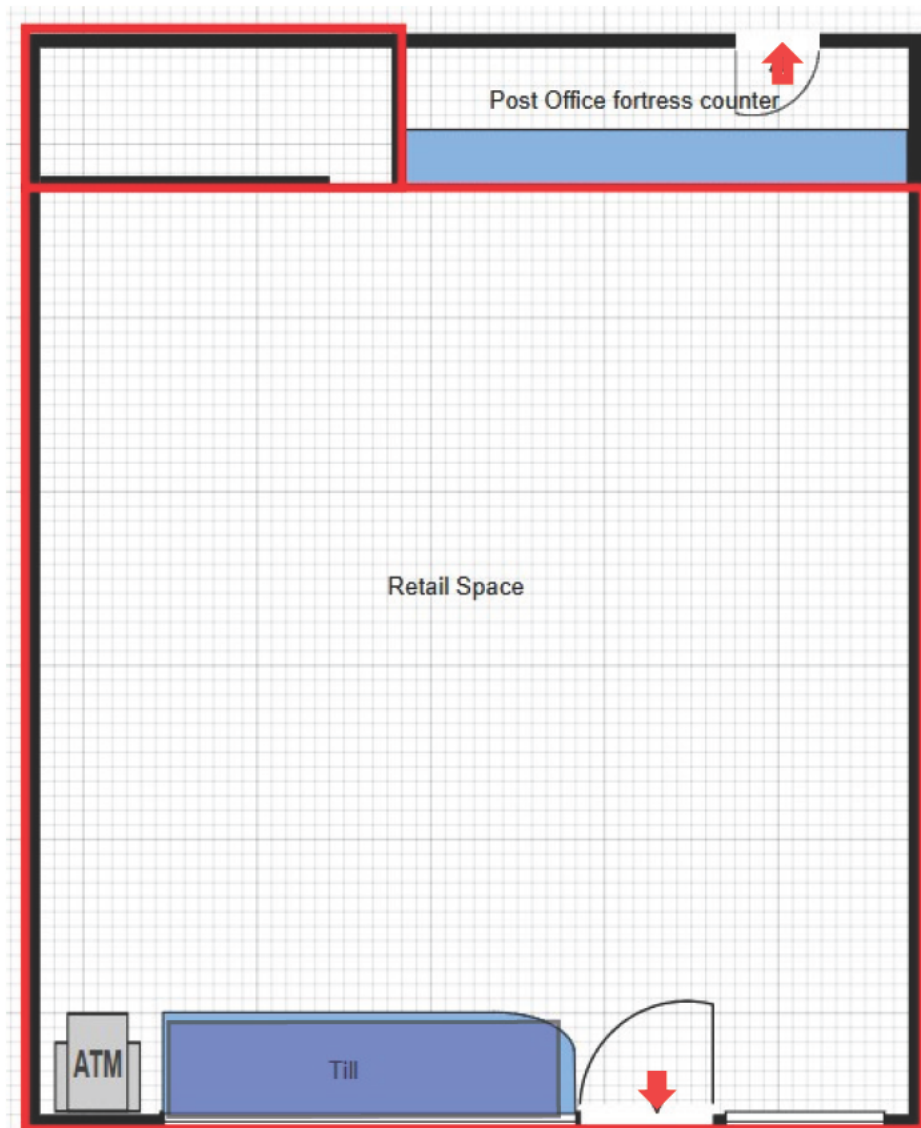
LI Retail, 24 Bridgeway Center, The Meadows, Nottingham, NG2 2JD



-  Till
-  Supply of alcohol
-  Fire exit

Scale: 1:100 @ A1